

wilson
LED
DESIGN LIGHTING

...innovative LED lighting solutions

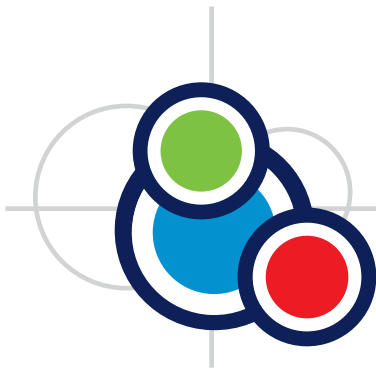



wilson
LED
DESIGN LIGHTING

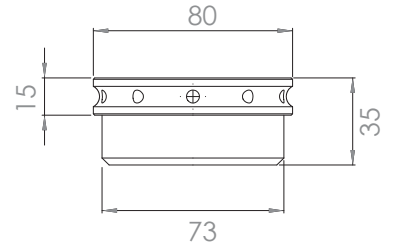

Product code: UFO8035

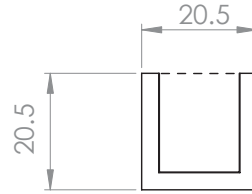

Product code: 2020
nominated length (max. 3000mm)

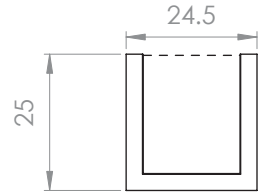

Product code: 2525
nominated length (max. 3000mm)

...innovative LED lighting solutions



Unique LED strip lighting and LED products for all commercial, architectural, building, landscape and water feature applications.

This universal product is exclusive in design and solitary in the market place, not only is it revolutionary for its time but is environmentally friendly as well. By working with our team at Wilson LED Design Lighting we offer you an exclusive experience to you and your business. Our dedication to meet your needs and further your business is our priority.

For quality assurance and efficiency to your business needs our products are Australian made and more conveniently, locally manufactured.

LED Strips are great for back lighting, accent lighting, decorative or feature lighting and are mountable into almost any surface or environment. The light output from each LED blends consistently due to the uniquely designed resin, resulting in a most uniform luminescence.

Product code: PINS1
nominated length (max. 3000mm)

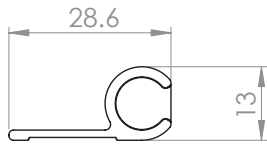

Product code: PINS2
nominated length (max. 3000mm)

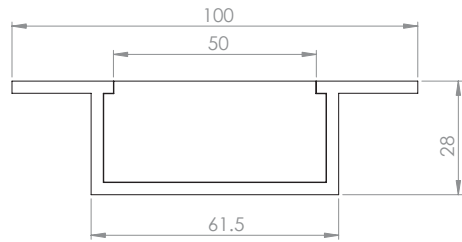
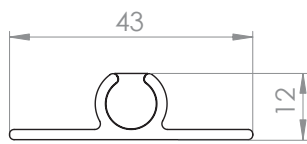

Product code: FLANGE2860

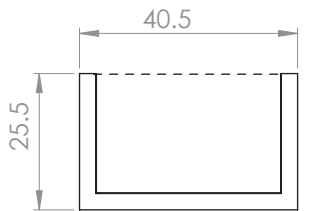

Product code: 2540
nominated length (max. 3000mm)

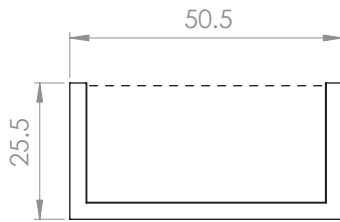

Product code: 2550
nominated length (max. 2000mm)

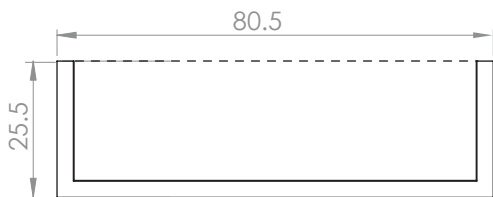

Product code: 2580
nominated length (max. 1500mm)

Applications

- Where space for the light source is limited
- Pelmet lighting, landscape feature lighting, edge lighting, accent lighting, decorative lighting, feature lighting
- In applications where the light source is exposed to the viewer and glare be minimised
- In environments subject to vandalism
- In environments where fittings are exposed to dust, water and UV light
- Where minimal heat & low voltage make the lights safe to use in public areas
- In areas of high volume pedestrian traffic

We offer Customised LED Lighting Solutions and advice for LED Light Design

- Fitting installation solutions
- Fitting design
- Preprogrammed lighting
- Selecting compatible controllers

Strip and Light Body Finish

- Powdercoat
- Anodised
- Natural Mill Finish
- Stainless Steel (not available in all channel sizes)

Moving forward with Wilson LED Design Lighting

- IP68 (2.0m)
- UV protected
- Vandal resistant
- No shock hazard
- Energy and cost efficient
- Safe for use in public areas
- Low Maintenance
- 12 month manufacturers warranty

Electrical Specifications

- 12v DC
- Watts per metre
 - 20x20 – 4.8w per metre
 - 25x25 – 4.8w per metre
 - 25x40 – 9.6w per metre
 - 25x50 – 14.4w per metre
 - 25x80 – 19.2w per metre
- LED Drivers available – 30/60/90/150 watts
- Strips pre wired with 500mm tail

Our products come in a range of colours and designs for personalised uniqueness

- | | |
|---------------------|-------------------------|
| ● - Red (R) | ● - DigiRed (DR) |
| ● - Green (G) | ● - DigiGreen (DG) |
| ● - Blue (B) | ● - DigiBlue (DB) |
| ○ - White (W) | ○ - DigiWhite (DW) |
| ● - Warm white (WW) | ● - DigiWarmWhite (DWW) |
| ● - Orange (O) | ● - DigiAmber (DA) |
| ● - Amber (A) | ● - DigiRGB (DRGB) |
| ● - RGB (RGB) | |

Please note: colours are indicative only.

* Specifications subject to change without notice.





info@leddesignlighting.com.au Phone 1300 720 979 Fax 1300 720 989 www.leddesignlighting.com.au

